

PHE 80GCSESRB

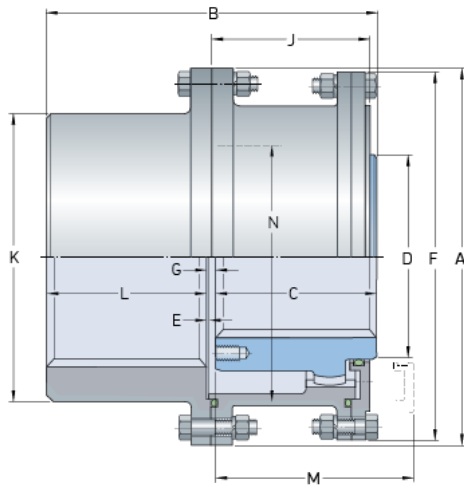

Size	80 GCSE
Power per 100 r/min (kW)	1780
Power per 100 r/min (HP)	2386.06
Rated torque (Nm)	170000
Rated torque (lbft)	125385.57
Speed Max. (r/min)	1750
Bore diameter Flex hub Max. (mm)	279
Bore diameter Flex hub Max. (in)	10.98
Bore diameter Se hub Max. (mm)	343
Bore diameter Se hub Max. (in)	13.5
Bore diameter Min. (mm)	102
Bore diameter Min. (in)	4.02
A (mm)	591
A (in)	23.27
B (mm)	511
B (in)	20.12
C (mm)	249
C (in)	9.8
D (mm)	356

® SKF is a registered trademark of the SKF Group

© SKF Group 2012

The contents of this publication are the copyright of the publisher and may not be reproduced (even extracts) unless prior written permission is granted. Every care has been taken to ensure the accuracy of the information contained in this publication but no liability can be accepted for any loss or damage whether direct, indirect or consequential arising out of the use of the information contained herein.

D (in)	14.02
E (mm)	-
E (in)	-
F (mm)	572
F (in)	22.52
H (mm)	-
H (in)	-
J (mm)	243
J (in)	9.57
K (mm)	450.8
K (in)	17.75
L (mm)	249
L (in)	9.8
M (mm)	300
M (in)	11.81
Q (mm)	-
Q (in)	-
Gap G Min. (mm)	13
Gap G Min. (in)	0.51
Lubricant mass (kg)	4.99
Lubricant mass (lbs)	11
Coupling mass without bore (kg)	698.5
Coupling mass without bore (lbs)	1539.93