

PHF FX120-45X73

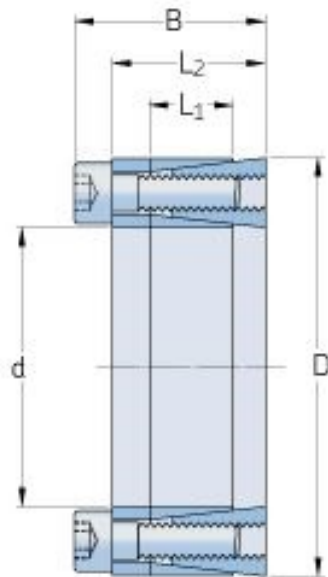

Número do casquilho	FX120
d (mm)	45
d (in)	1.77
D (mm)	73
d _w (mm)	-
L (mm)	-
L ₁ (mm)	18
L ₂ (mm)	28
L ₃ (mm)	-
B (mm)	36
D ₁ (mm)	-
d ₁ (mm)	-
e (mm)	-
F _t (kN) Força axial transmissível (kN)	-
M _t (Nm) Torque transmissível (Nm)	1500
P _w Pressão de superfície de eixo (N/mm ²)	210
P _n Pressão de superfície de cubo (N/mm ²)	130
Quantidade de	12

® SKF is a registered trademark of the SKF Group

© SKF Group 2012

The contents of this publication are the copyright of the publisher and may not be reproduced (even extracts) unless prior written permission is granted. Every care has been taken to ensure the accuracy of the information contained in this publication but no liability can be accepted for any loss or damage whether direct, indirect or consequential arising out of the use of the information contained herein.

parafusos de aperto	
Tamanho de parafuso de aperto	M8
Porca de parafuso de aperto	-
M _s Torque de aperto do parafuso (Nm)	41
Peso (kg)	-