

PHC 500RX10FT

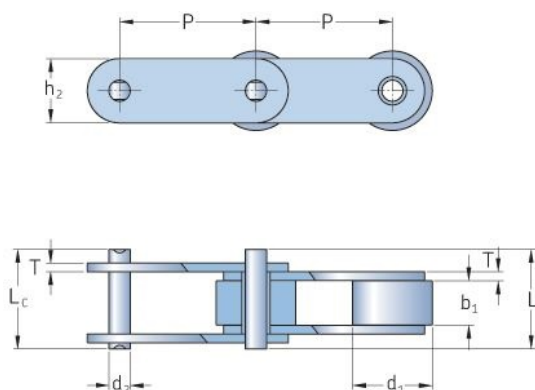

Passo P (mm)	50
Passo P (in)	1.97
Diâmetro do rolo d1 max (mm)	25.4
Roller diameter d1 max (in)	1
Distância entre as placas interiores (mm)	25.4
Width between inner plates b1 min (in)	1
Diâmetro de pino d2 max (mm)	14.63
L máx. de comprimento de pino (mm)	52
Pin length L max (in)	2.05
Lc máx. de comprimento de pino (mm)	56.4
Pin length Lc max (in)	2.22
Altura máxima da placa interna h2	40
Inner plate height h2 max (in)	1.57
Espessura da placa T max (mm)	5
Plate thickness T max (in)	0.2

® SKF is a registered trademark of the SKF Group

© SKF Group 2012

The contents of this publication are the copyright of the publisher and may not be reproduced (even extracts) unless prior written permission is granted. Every care has been taken to ensure the accuracy of the information contained in this publication but no liability can be accepted for any loss or damage whether direct, indirect or consequential arising out of the use of the information contained herein.

Limite de resistência à tração Q min	100
Ultimate tensile strength Q min (lb)	22480.89
Average tensile strength Qo (kN)	114.5
Average tensile strength Qo (lb)	4.51
Peso (kg/m)	7.13
Weight (lbs/ft)	4.79