

PHF TB2525X2.375

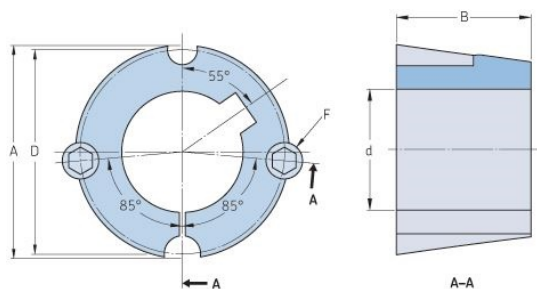

Bushing no.	TB2525
d = Bore diameter (mm)	60
Bore diameter (in)	2.36
Keyway width (mm)	15.9
Keyway width (in)	0.63
Keyway depth (mm)	5.6
Keyway depth (in)	0.22
A (mm)	85.7
A (in)	3.37
B (mm)	63.5
B (in)	2.5
D (mm)	82.6
D (in)	3.25
E (mm)	-
E (in)	-
F (mm)	-
F (in)	1/2 X 1
Weight (kg)	1.091
Weight (lbs)	2.41