

# PHF TB2525X1.125

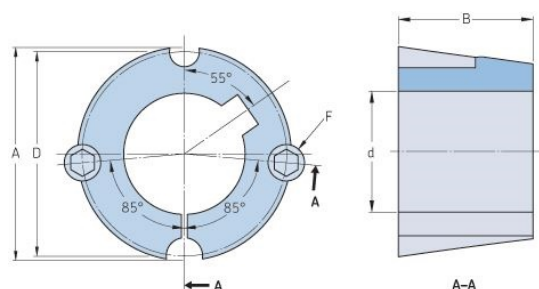

Bushing no.	TB2525
d = Bore diameter (mm)	29
Bore diameter (in)	1.14
Keyway width (mm)	7.9
Keyway width (in)	0.31
Keyway depth (mm)	3.2
Keyway depth (in)	0.13
A (mm)	85.7
A (in)	3.37
B (mm)	63.5
B (in)	2.5
D (mm)	82.6
D (in)	3.25
E (mm)	-
E (in)	-
F (mm)	-
F (in)	1/2 X 1
Weight (kg)	1.841
Weight (lbs)	4.06