

# PHE L095-24MMP

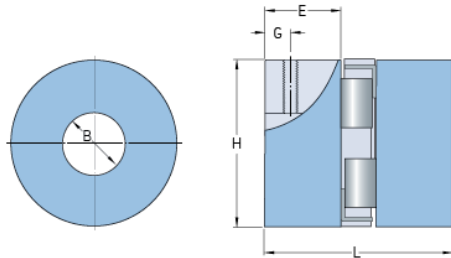

Size	95
Position threaded hole G (mm)	11
Position threaded hole G (in)	0.43
Outer diameter H (mm)	54
Outer diameter H (in)	2.13
Maximum bore	28
Maximum bore (in)	-
Set screw	M8
Length E (mm)	25
Length E (in)	0.98
Bore	24
Bore (in)	0.94