

PHF TB2017X45MM

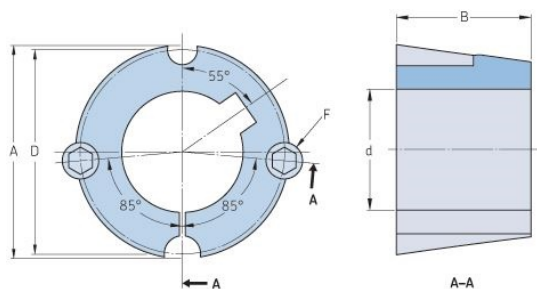

| | |
|------------------------|-----------------|
| Bushing no. | TB2017 |
| d = Bore diameter (mm) | 45 |
| Bore diameter (in) | 1.77 |
| Keyway width (mm) | 14 |
| Keyway width (in) | 0.55 |
| Keyway depth (mm) | 3.8 |
| Keyway depth (in) | 0.15 |
| A (mm) | 69.9 |
| A (in) | 2.75 |
| B (mm) | 44.5 |
| B (in) | 1.75 |
| D (mm) | 66.7 |
| D (in) | 2.63 |
| E (mm) | - |
| E (in) | - |
| F (mm) | 11.113 x 22.225 |
| F (in) | - |
| Weight (kg) | 0.56 |
| Weight (lbs) | 1.23 |