

## PHF TB2017X0.625

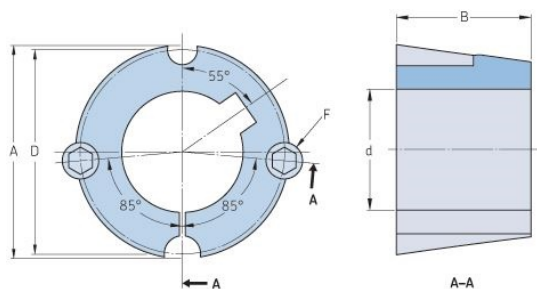

Bushing no.	TB2017
d = Bore diameter (mm)	16
Bore diameter (in)	0.63
Keyway width (mm)	4.8
Keyway width (in)	0.19
Keyway depth (mm)	2.4
Keyway depth (in)	0.09
A (mm)	69.9
A (in)	2.75
B (mm)	44.5
B (in)	1.75
D (mm)	66.7
D (in)	2.63
E (mm)	-
E (in)	-
F (mm)	11.113 x 22.225
F (in)	-
Weight (kg)	1.05
Weight (lbs)	2.31